

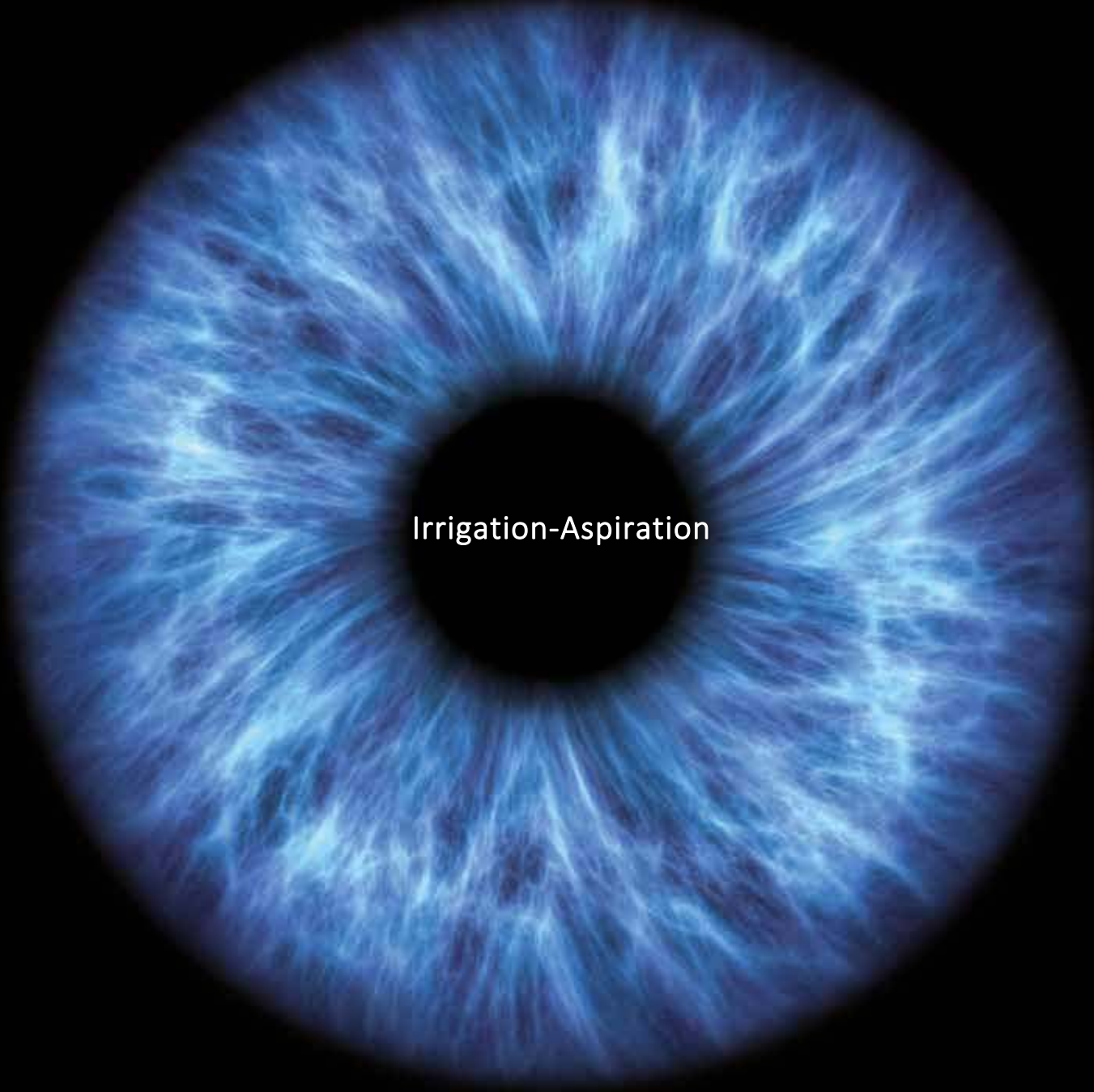

OPHTALMO



Irrigation-Aspiration

THIS IS WHAT THE FUTURE LOOKS LIKE



## Irrigation & Aspiration

- I/A Handpieces (21 and 23 Gauge)
- Aspiration Tips
- Coaxial Handpieces
- Phaco Wrench
- I/A Cannulas and Cannula Handle
- Irrigating Cannulas
- Infusion and AC Maintainers





## Titanium Reusable Ophthalmic Instruments

## Irrigation Handpiece

Best Seller 8-650

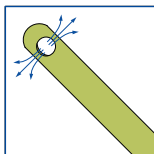

## Irrigation Handpiece

- **21 gauge, 0.8mm tube diameter**
- **Two 0.5mm irrigation ports**
- Curved shaft, tube length 15mm
- Round handle, overall length 107mm
- Suggested Pairing: **8-655**

## Irrigation Handpiece

8-650-1

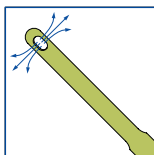

## Avolio Irrigation Handpiece

- **21 gauge, 0.8mm tube diameter**
- **Flattened tip for first 5mm**
- **Two 0.5mm equivalent side irrigation ports**
- Curved shaft, tube length 15mm
- Round handle, overall length 107mm
- Suggested Pairing: **8-655-1**

## Irrigation Handpiece

8-650-2

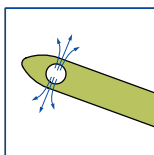

## Irrigation Handpiece

- **21 gauge, 0.8mm tube diameter**
- **Bullet shaped tip**
- **Two 0.5mm irrigation ports**
- Curved shaft, tube length 22mm
- Round handle, overall length 115mm
- Suggested Pairing: **8-655-2**

## Aspiration Handpiece

Best Seller 8-655

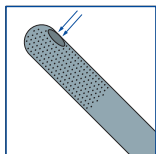

## Aspiration Handpiece

- **21 gauge, 0.8mm tube diameter, textured tip**
- 0.35mm aspiration port
- Curved shaft, tube length 15mm
- Round handle, overall length 107mm
- Suggested Pairing: **8-650**

## Aspiration Handpiece

8-655-1

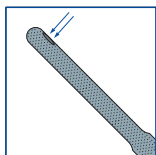

## Avolio Aspiration Handpiece

- **21 gauge, 0.8mm tube diameter**
- **Flattened textured tip for first 5mm**
- 0.35mm aspiration port
- Curved shaft, tube length 15mm
- Round handle, overall length 107mm
- Suggested Pairing: **8-650-1**

## Aspiration Handpiece

8-655-2

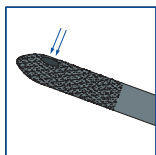

## Aspiration Handpiece

- **21 gauge, 0.8mm tube diameter with textured tip**
- **Bullet shaped tip**
- 0.35mm aspiration port
- Curved shaft, tube length 22mm
- Round handle, overall length 115mm
- Suggested Pairing: **8-650-2**



## Irrigation Handpiece

Best Seller 8-652

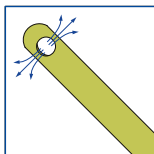

## Irrigation Handpiece

- **23 gauge, 0.65mm tube diameter**
- **Two 0.4mm side irrigation ports**
- Curved shaft, tube length 15mm
- Round handle, overall length 107mm
- Suggested Pairing: **8-657**

## Irrigation Handpiece

Best Seller 8-652-1

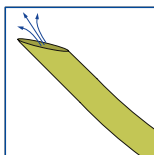

## Irrigation Handpiece

- **23 gauge, 0.65mm tube diameter**
- **Open end 0.5mm irrigation port, 30° angled face**
- Curved shaft, tube length 11mm
- Round handle, overall length 103mm
- Suggested Pairing: **8-657**

## Aspiration Handpiece

Best Seller 8-657

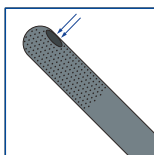

## Aspiration Handpiece

- **23 gauge, 0.65mm tube diameter, textured tip**
- 0.3mm aspiration port
- Curved shaft, tube length 11mm
- Round handle, overall length 104mm
- Suggested Pairing: **8-652** or **8-652-1**

## Irrigation Handpiece

8-652S

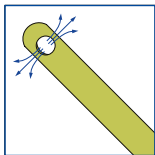

## Irrigation Handpiece

- **23 gauge, 0.65mm tube diameter**
- Two 0.4mm side irrigation ports
- Curved shaft, tube length 15mm
- **Round handle, overall length 80mm**
- Suggested Pairing: **8-657S**

## Irrigation Handpiece

8-652-1S

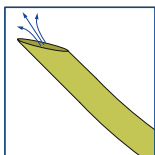

## Irrigation Handpiece

- **23 gauge, 0.65mm tube diameter**
- **Open end 0.5mm irrigation port, 30° angled face**
- Curved shaft, tube length 11mm
- **Round handle, overall length 76mm**
- Suggested Pairing: **8-657S**

## Aspiration Handpiece

8-657S

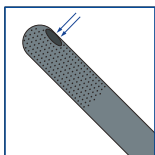

## Aspiration Handpiece

- **23 gauge, 0.65mm tube diameter, textured tip**
- 0.3mm aspiration port
- Curved shaft, tube length 11mm
- **Round handle, overall length 77mm**
- Suggested Pairing: **8-652S** or **8-652-1S**





Aspiration Tips to be used in conjunction with 8-711 series I/A Handpieces (see page 139)

**Port Size**

0.25mm and 0.3mm options available

**Texture**

Majority of tips have no texture, 8-731-4 and 8-732-4 are half textured

**Shape**

Four variations available 90° angle, 45° angle, curved and straight

**More Details...**

For full product details visit:  
[duckworth-and-kent.com](http://duckworth-and-kent.com)





## Instrument Comparison Chart

### Product Name - I/A Tip

#### 22 Gauge / 0.7mm Tube Diameter

Port Size	Shape	Texture	Additional Information	
0.25mm	90° Angled	None	Aspiration Tip, 90° Angled Tip	8-730
	45° Angled	None	Aspiration Tip, 45° Angled Tip	8-730-1
0.3mm	90° Angled	None	Aspiration Tip, 90° Angled Tip	8-731
	45° Angled	None	Aspiration Tip, 45° Angled Tip	8-731-1
	Straight	None	Aspiration Tip, Straight Tip	8-731-3
	Curved	Half	Aspiration Tip, Curved Tip	8-731-4

#### 20 Gauge / 0.9mm Tube Diameter

Port Size	Shape	Texture	Additional Information	
0.3mm	90° Angled	None	Aspiration Tip, 90° Angled Tip	8-732
	45° Angled	None	Aspiration Tip, 45° Angled Tip	8-732-1
	Straight	None	Aspiration Tip, Straight Tip	8-732-3
	Curved	Half	Aspiration Tip, Curved Tip	8-732-4

Best Sellers

#### Shape

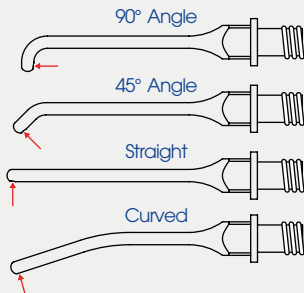

#### Texture

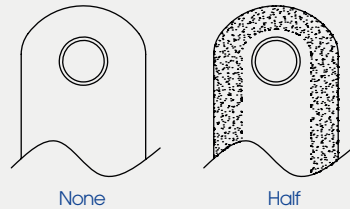

## I/A Handpiece

8-711N

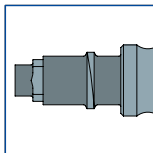

## I/A Handpiece, Push Fit

- Round handle, overall length 115mm
- Separates for cleaning internal parts
- **Single thread at front of handpiece**
- Used with 8-730, 8-731 and 8-732 series aspiration tips
- Aspiration tips purchased separately
- Silicone sleeve is pushed onto single thread
- Silicone sleeve not included

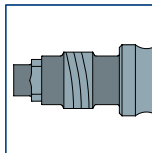

8-711-1N

## I/A Handpiece, Screw Fit

- **Multi-thread at front of handpiece**

## I/A Handpiece

8-711NL

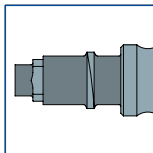

## I/A Handpiece with Luer Lock, Push Fit

- Round handle, overall length 115mm
- Separates for cleaning internal parts
- **Luer lock fitting on irrigation port**
- **Single thread at front of handpiece**
- Used with 8-730, 8-731 and 8-732 series aspiration tips
- Aspiration tips purchased separately
- Silicone sleeve is pushed onto single thread
- Silicone sleeve not included

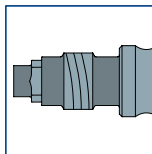

8-711-1NL

## I/A Handpiece, Screw Fit

- **Multi-thread at front of handpiece**

## Phaco Wrench

8-001

## Phaco Wrench

- For use with Alcon fitting needles and all D&K aspiration tips (8-730 series, 8-731 series and 8-732 series)

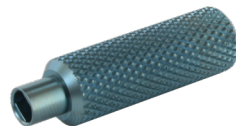

## Cannula

Best Seller

8-635

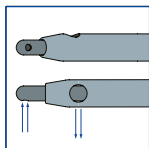

## Ogawa I/A Cannula

- **18 gauge, thin wall**
- 0.8mm irrigation port, 0.3mm aspiration port
- 30° angled shaft, tip to angle length 6mm
- Coaxial irrigation and aspiration
- Irrigation attaches directly to main hub
- Syringe attaches to luer fitting for aspiration
- Silicone tubing and luer fitting supplied



## Cannula

8-635-3

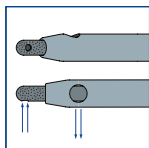

## Ogawa I/A Cannula

- **18 gauge, thin wall**
- 0.8mm irrigation port, 0.3mm aspiration port
- 30° angled shaft, tip to angle length 6mm
- **Knurled hub enhances grasp**
- **Textured tip**
- Coaxial irrigation and aspiration
- Irrigation attaches directly to main hub
- Syringe attaches to luer fitting for aspiration
- Silicone tubing and luer fitting supplied



## Cannula Handle

8-720



## Cannula Handle

- **Specifically made for use with 8-601 series, 8-602, 8-603 and 8-604**
- Overall length 99mm



## Cannula

8-601

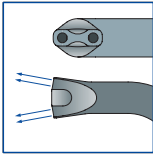

## Inamura Hyper-Hydrodissection Cannula

- 22 gauge tube (0.7mm diameter)
- 0.9mm x 0.3mm flattened tip
- Twin jets, inclusive angle **20°**
- 45° angled tip
- Overall length 36mm

## Cannula

8-601-1

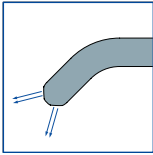

## Inamura Hydrodissection Cannula

- 22 gauge tube (0.7mm diameter)
- Twin jets, inclusive angle **60°**
- 45° angled tip
- Overall length 36mm

8-601-2

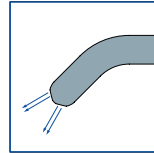

## Inamura Multipurpose Cannula

- Twin jets, inclusive angle **30°**

## Cannula

Best Seller 8-602

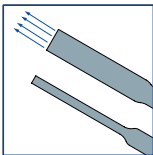

## Mackool Hydrodissection Cannula

- 23 gauge tube (0.65mm diameter)
- 0.85mm x 0.3mm flattened tip
- 30° angled shaft, tip to angle length 8mm
- Overall length 35mm

## Cannula

8-603

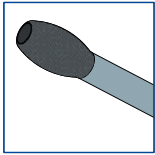

### Capsule Polishing Cannula, 23 Gauge

- 23 gauge tube (0.65mm diameter)
- 1.75mm x 1mm olive shaped textured tip
- 30° curved shaft
- Overall length 34mm

## Cannula

8-604

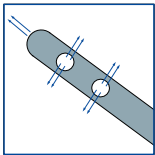

### LASIK Cannula

- 23 gauge tube (0.65mm diameter)
- 0.2mm diameter hole at tip
- Four 0.4mm diameter holes along side of shaft
- 25° angled shaft, tip to angle length 8mm
- Overall length 30mm

## Cannula

8-605

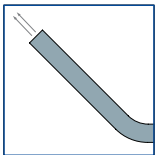

### Air Injection Cannula

- 23 gauge tube (0.65mm diameter)
- 45° angled shaft, tip to angle length 5mm
- Overall length 35mm

## Cannula

8-615-1

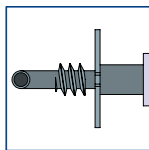

### Rassam Infusion Cannula

- **20 gauge, thin wall, 0.9mm diameter x 4.2mm length**
- Straight shaft, 45° bevelled tip
- 3 x 0.5mm pitched thread
- 5mm plate diameter
- Silicone tubing and luer fitting supplied

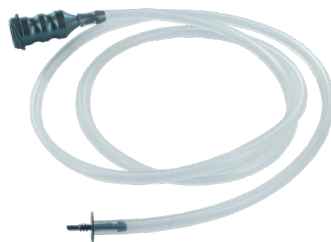

## Cannula

Best Seller 8-616

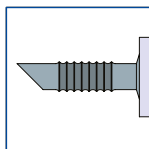

### Ogawa Infusion Cannula, 20 Gauge

- **20 gauge, thin wall, 0.9mm diameter x 4mm length**
- Straight shaft, 45° bevelled tip
- Grooves in cannula body ensure non-traumatic securing of cannula
- **Knurled hub enhances grip**
- Silicone tubing overall length 410mm
- Silicone tubing and luer fitting supplied



8-616-1

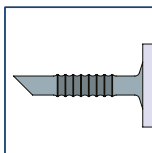

### Ogawa Infusion Cannula, 23 Gauge

- **23 gauge, thin wall, 0.65mm diameter x 4mm length**
- **Fits through 0.9mm paracentesis opening**

## Cannula

8-644

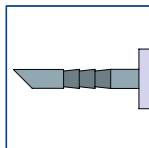

### Infusion Cannula, 23 Gauge

- **23 gauge, thin wall, 0.65mm diameter x 4mm length**
- Straight shaft, 45° bevelled tip
- **Fits through 0.9mm paracentesis opening**
- Silicone tubing and luer fitting supplied



**Precision engineered irrigation and aspiration handpieces.**  
Consistent high flow rates.

Tube sizes range from 21 gauge (0.8mm diameter) to 23 gauge (0.65mm diameter).

Precision made tips and tubes, produced from a single piece of titanium with no fabrication. Guaranteed quality.

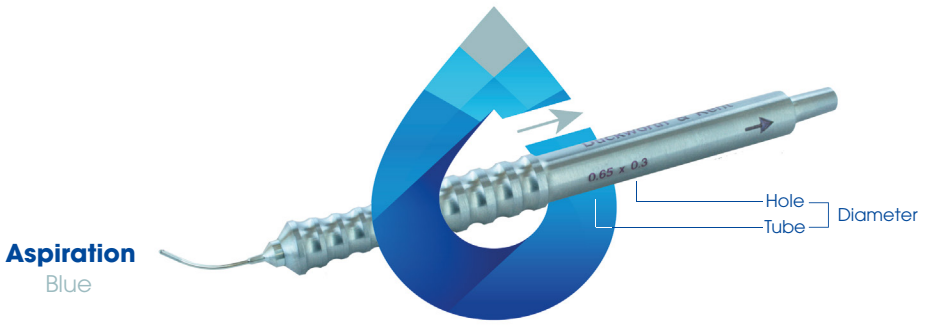
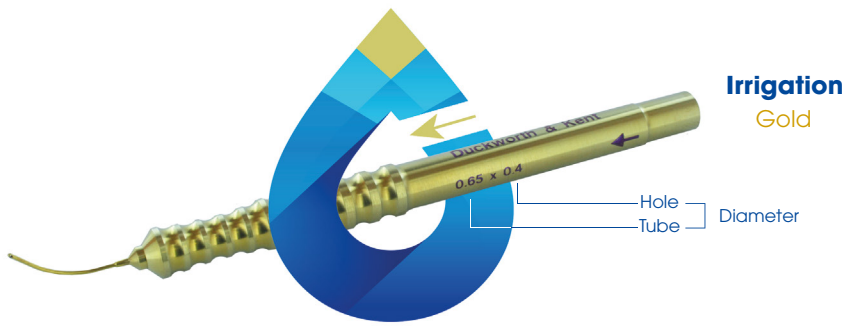

**Coaxial handpieces and tips**

Available with single/multi thread/luer lock options. Separates for cleaning internal parts.



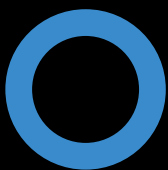

OPHTALMO  
THIS IS WHAT THE FUTURE LOOKS LIKE

- SURGICAL
- CONSUMABLES
- MEDICAL DEVICE