

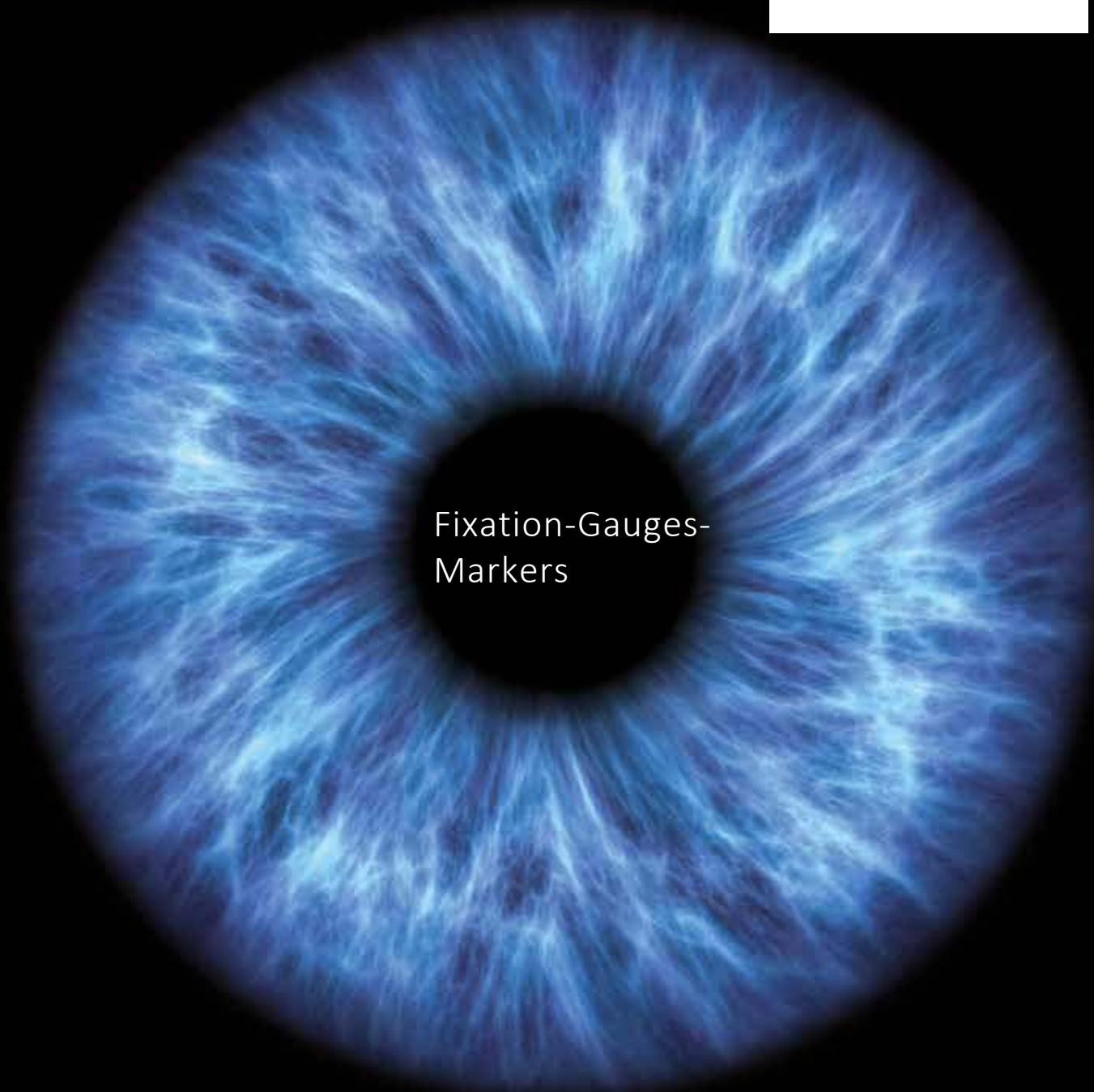

OPHTALMO



Fixation-Gauges-  
Markers

THIS IS WHAT THE FUTURE LOOKS LIKE



## Fixation Rings, Gauges and Markers

- Fixation Rings
- CCC Markers
- Ring Markers
- Corneal Blade Markers
- LASIK Markers
- DMEK Markers
- Axis Blade Markers
- Degree Gauges
- Toric Markers
- Incision Markers
- Intravitreal Injection Guides
- Calipers
- Incision Gauges





## Titanium Reusable Ophthalmic Instruments

## Fixation Ring

9-509

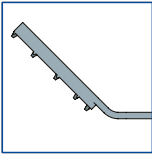

### Thornton Fixation Ring

- 3/4 ring, **13mm** diameter ring with ten point fixation
- Fixed flat handle, overall length 114mm

## Fixation Ring

Best Seller 9-510

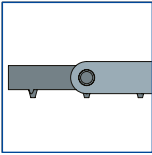

### Thornton Fixation Ring

- 3/4 ring, **13mm** diameter ring with ten point fixation
- Pivot swivel flat handle, overall length 104mm

## Fixation Ring

Best Seller 9-510R

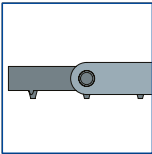

### Thornton Fixation Ring

- 3/4 ring, **13mm** diameter ring with ten point fixation
- Pivot swivel round handle, overall length 112mm

## Fixation Ring

9-515R

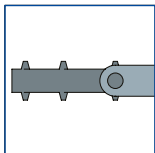

### Thornton Fixation Ring

- 3/4 offset ring, **13mm** diameter ring **dual-sided** with ten point fixation
- Pivot swivel round handle, overall length 113mm

## Fixation Ring

9-503

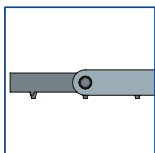

### Thornton Fixation Ring

- 3/4 ring, **16mm** diameter ring with ten point fixation
- Pivot swivel flat handle, overall length 106mm

## CCC Marker

9-518-1

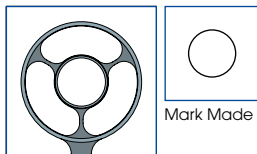

## Fujimoto CCC Guide, Ø5.3mm

- 12mm diameter outer ring
- Inner capsulorhexis guide **5.3mm** diameter ring
- Smooth surface to mark cornea
- Fixed flat handle, overall length 99mm

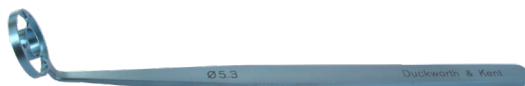

## CCC Marker

9-518-2

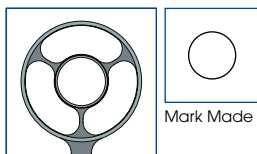

## Fujimoto CCC Guide, Ø5.6mm

- 12mm diameter outer ring
- Inner capsulorhexis guide **5.6mm** diameter ring
- Smooth surface to mark cornea
- Fixed flat handle, overall length 99mm



## CCC Marker

9-518-2R

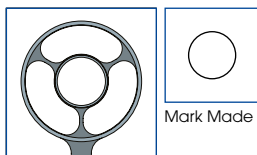

## Fujimoto CCC Guide, Ø5.6mm

- 12mm diameter outer ring
- Inner capsulorhexis guide **5.6mm** diameter ring
- Smooth surface to mark cornea
- Fixed round handle, overall length 99mm

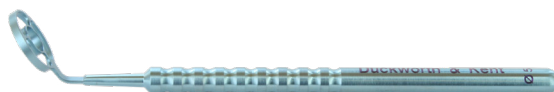

## CCC Marker

9-518-3

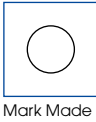

### Ota-Fujimoto CCC Marker, Ø5.6mm

- **5.6mm** diameter ring, low profile with centre pointer
- Round handle, overall length 94mm

## CCC Marker

Best Seller

9-518-4



### Donoso Capsulorhexis Marker, Ø6.5mm

- Castellated ring which marks five segments of a 6.5mm diameter on the cornea, approximating to a 5.5mm diameter capsulorhexis
- Round handle, overall length 125mm

## Ring Marker

9-778

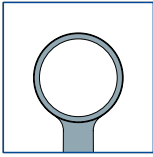

### Ring Marker, Ø5.0mm

- **5mm** diameter ring, low profile
- Round handle, overall length 122mm

## Ring Marker

9-779

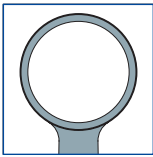

### Ring Marker, Ø6.0mm

- **6mm** diameter ring, low profile
- Round handle, overall length 123mm

## Ring Marker

Best Seller 9-781

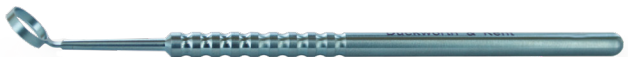
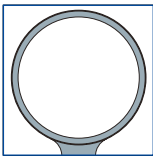

### Ring Marker, Ø8.0mm

- **8mm** diameter ring, low profile
- Round handle, overall length 124mm



## Ring Marker

9-781W

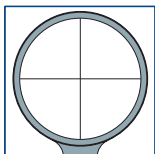

### Ring Marker with Cross Wires, Ø8.0mm

- **8mm** diameter ring
- Low profile with **cross wires**
- Round handle, overall length 125mm

## Ring Marker

9-788

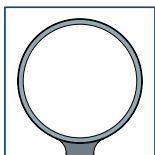

### Ring Marker, Ø9.0mm

- **9mm** diameter ring, low profile
- Round handle, overall length 125mm

## Ring Marker

9-789W-1

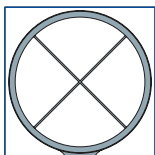

### Ring Marker with Cross Wires, Ø11.0mm

- **11mm** diameter ring
- Low profile with **cross wires**
- Round handle, overall length 126mm

## Blade Marker

9-732

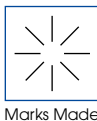
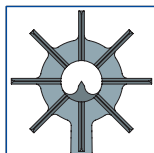

Marks Made

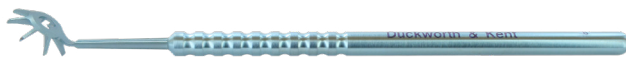

### Thornton Radial Marker, 8 Blades

- **8 radial blades**
- 4mm inside diameter, 13mm outside diameter
- Lowest profile with centre pointer
- Round handle, overall length 128mm

## Blade Marker

9-733

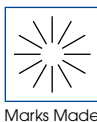
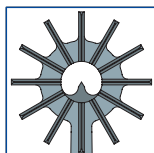

Marks Made

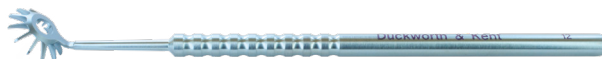

### Thornton Radial Marker, 12 Blades

- **12 radial blades**
- 4mm inside diameter, 13mm outside diameter
- Lowest profile with centre pointer
- Round handle, overall length 128mm

## Blade Marker

9-734

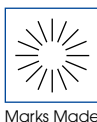
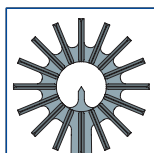

Marks Made

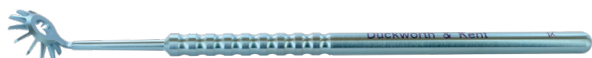

### Thornton Radial Marker, 16 Blades

- **16 radial blades**
- 5mm inside diameter, 13mm outside diameter
- Lowest profile with centre pointer
- Round handle, overall length 128mm

## LASIK Marker

9-854R

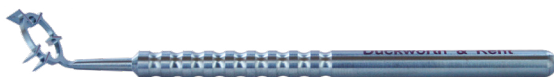
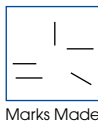
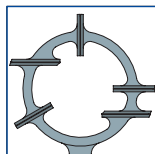

## LASIK Marker

- Lowest profile with three radial elements and two non-radial elements
- Round handle, overall length 98mm

## LASIK Marker

9-855

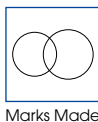
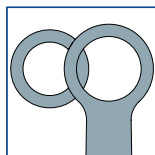

## Gulani LASIK Marker

- 3.5mm and 4mm intersecting circles
- Round handle, overall length 122mm

## S Marker

9-830

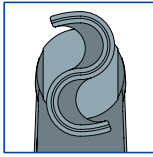

Mark Made



## DMEK 'S' Marker

- 1.25 x 2.5mm **high 'S' mark**
- 35° angled handle
- Round handle, overall length 96mm

## F Marker

9-831

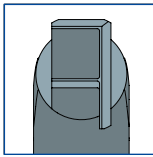

Mark Made

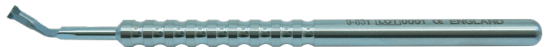

## DMEK 'F' Marker

- 1.1 x 2.25mm **high 'F' mark**
- 35° angled handle
- Round handle, overall length 96mm

## Blade Marker

9-729

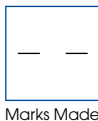
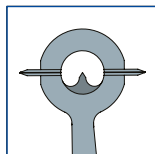

### Axis Marker, 2 Blades

- **2 axial blades**
- 4mm inside diameter, 11.6mm outside diameter
- Lowest profile with centre pointer
- Round handle, overall length **124mm**

## Blade Marker

Best Seller 9-729-1

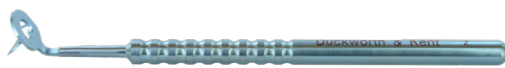
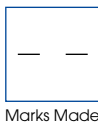
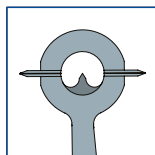

### Axis Marker, 2 Blades

- **2 axial blades**
- 4mm inside diameter, 11.6mm outside diameter
- Lowest profile with centre pointer
- Round handle, overall length **95mm**

## Blade Marker

9-730

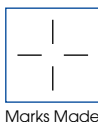
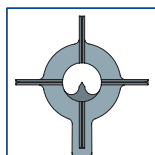

### Thornton Radial Marker, 4 Blades

- **4 radial blades**
- 4mm inside diameter, 13mm outside diameter
- Lowest profile with centre pointer
- Round handle, overall length **128mm**

## Degree Gauge

9-700

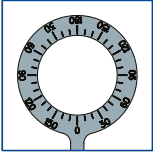

## Mendez Degree Gauge

- Marks 0° - 180° in **10° increments** x 2
- 12mm internal ring diameter
- 40° angled handle
- Flat handle, overall length 116mm

## Degree Gauge

9-705R

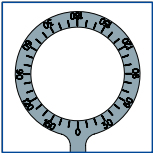

## Wallace-Mendez Degree Gauge

- Measures 0° - 180° in **10° increments** x 2
- 12mm internal ring diameter
- 60° angled handle
- Round handle, overall length 102mm

## Degree Gauge

Best Seller 9-705R-1

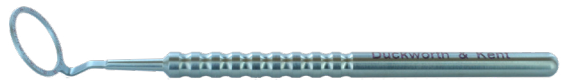
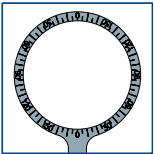

## Mendez Degree Gauge

- Marks 0° - 180° in **5° increments** x 2
- 12mm internal ring diameter
- 60° angled handle
- Round handle, overall length 103mm

## Toric Marker

Best Seller 9-840

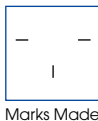
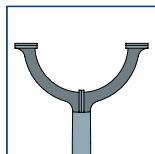

### Cionni Toric Reference Marker

- **3 blades**, radial marks
- **10mm** inside diameter, **15mm** outside diameter
- 70° angled shaft
- Round handle, overall length 124mm

## Toric Marker

9-840-1

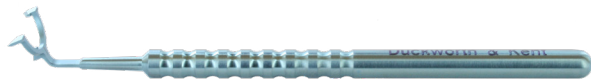
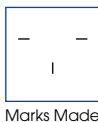
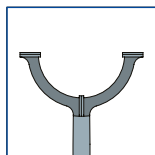

### Cionni Toric Reference Marker

- **3 blades**, radial marks
- **8.5mm** inside diameter, **12.75mm** outside diameter
- 70° angled shaft
- Short round handle, overall length 96mm

## Toric Marker

9-840-3

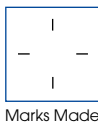
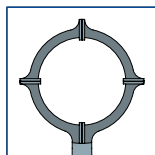

### Toric Reference Marker, 4 Blades

- **4 blades**, radial marks
- **8.5mm** inside diameter, **12.75mm** outside diameter
- 70° angled shaft
- Short round handle, overall length 98mm

## Toric Marker

Best Seller 9-841

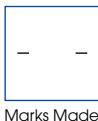
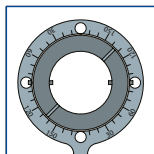

## Cionni Toric Axis Marker

- **2 rotating blades**, radial marks
- **11mm** inside diameter, **15mm** outside diameter
- Marks 0° to 180° in **10° increments**
- 40° angled shaft
- Flat handle, overall length 116mm

## Toric Marker

9-841-1

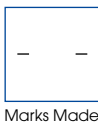
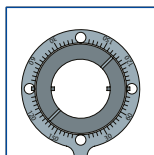

## Cionni Toric Axis Marker

- **2 rotating blades**, radial marks
- **9.35mm** inside diameter, **12.75mm** outside diameter
- Marks 0° to 180° in **5° increments**
- 40° angled shaft
- Flat handle, overall length 116mm

## Toric Marker

9-841-2

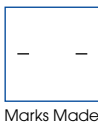
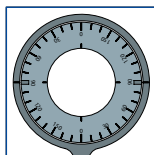

## Barrett Toric Axis Marker

- **2 fixed blades**, orientated 90° to handle
- **11mm** inside diameter, **15mm** outside diameter
- Rotating dial marks 0° to 180° in **10° increments**
- 40° angled shaft
- Flat handle, overall length 116mm



## Toric Marker

9-841-3

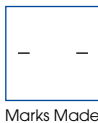
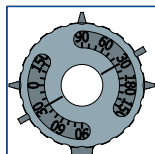

### R J Mackool™ Toric Axis Marker

- **2 rotating blades**, radial marks
- **9mm** inside diameter, **12.8mm** outside diameter
- Marks 0° to 180° in **10° increments**
- 3 non-marking reference blades
- 45° angled shaft
- Round handle, overall length 127mm
- US Patent No. 9,011,470

## Toric Marker

9-841-4

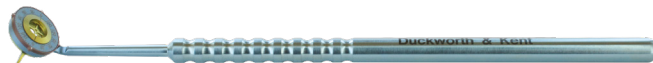
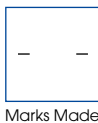
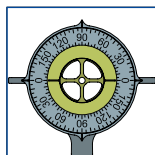

### Barrett Toric Axis Marker

- Two dials, one outer and one inner
- Two marking blades
- Marks 0° to 180° in **5° increments**
- 45° angled shaft
- Round handle, overall length 125mm



## Incision Marker

9-845

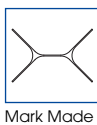
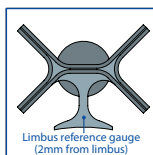

### Ota 'Y' Incision Marker

- 4.3mm x 2.8mm marker
- **Double Y mark** for universal placement
- Reference gauge offsets marker 2mm from limbus
- Round handle, overall length 97mm

## Incision Marker

9-845-2

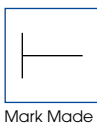
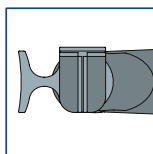

### Ota 'T' Incision Marker

- 1.5mm x 2mm **T shaped marker**
- Reference arm offsets marker 2mm from limbus
- Round handle, overall length 96mm

## Incision Marker

9-846

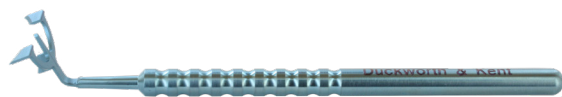
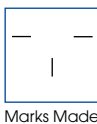
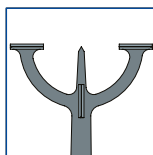

### Ota Reference Incision Marker

- 3 blades with centre point, **radial marks**
- 8mm inside diameter, 15mm outside diameter
- 70° angled shaft
- Round handle, overall length 97mm

## Incision Marker

9-847

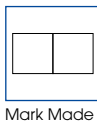
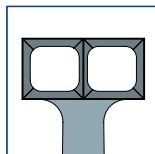

### Ota L-Pocket Incision Marker

- Marks **two squares** 3mm x 3mm, side by side
- Round handle, overall length 94mm



## Incision Marker

9-749

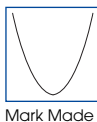
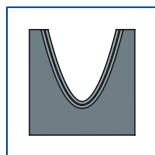

### Kearney Parabolic Marker

- 5mm x 5mm marker
- 1mm cross hatches
- Round handle, overall length 125mm



## Injection Guide

Best Seller 9-544

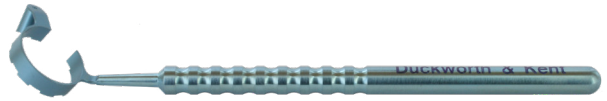
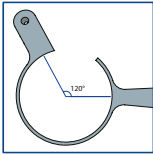

### Doi-Uematsu Intravitreal Injection Guide

- 0.5mm needle guide hole, suitable for 27 gauge needle or smaller
- 12mm diameter ring with 'snow-tyre pattern' fixation
- **5.5mm** break in ring
- Designed for the right handed surgeon to be held in the non-dominant hand
- Held in the non-dominant hand (left)
- Round handle, overall length 102mm
- PAT.P 2005.316218

## Injection Guide

9-544-2

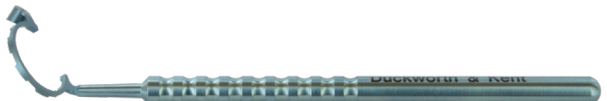
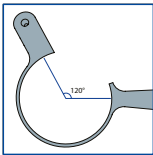

### Doi-Uematsu Intravitreal Injection Guide

- 0.5mm needle guide hole, suitable for 27 gauge needle or smaller
- 12mm diameter ring with 'snow-tyre pattern' fixation
- **8.4mm** break in ring
- Designed for the right handed surgeon to be held in the non-dominant hand
- Held in the non-dominant hand (left)
- Round handle, overall length 98mm

## Injection Guide

9-544-4

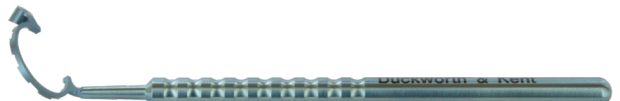
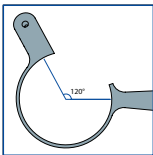

### Doi-Uematsu Intravitreal Injection Guide

- **0.4mm** needle guide hole, suitable for 30 gauge needle or smaller
- 12mm diameter ring with 'snow-tyre pattern' fixation
- **8.4mm** break in ring
- Designed for the right handed surgeon to be held in the non-dominant hand
- Round handle, overall length 98mm

## Marking Caliper

9-692

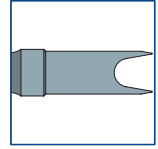
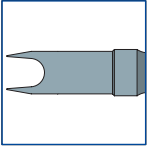

## Double Ended Caliper

- Double ended caliper marks 3.5mm and 4mm
- Marks from centre of caliper tips
- Round handle, overall length 99mm

## Marking Caliper

9-649

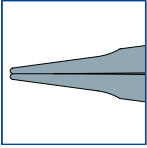

## Castroviejo Style Marking Caliper

- 0.25mm x 0.25mm delicate marking tips
- Marks **0mm to 20mm in 0.25mm** increments
- Marks from centre of tips
- Adjustable thumb screw
- Standard caliper handle

## Marking Caliper

Best Seller

9-650

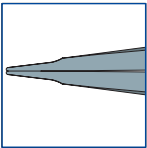

## Castroviejo Style Marking Caliper

- 0.25mm x 0.25mm delicate marking tips
- Marks **0mm to 15mm in 0.25mm** increments
- Marks from centre of tips
- Adjustable thumb screw
- Standard caliper handle



### Gauge Options

**Set of 7 individual incision gauges from 1mm to 3mm in 0.1mm increments.**

Gauges can be ordered individually.

### Gauge Sizes

Each individual gauge measures 3 sizes of 0.1mm increments.

### Colour Coding

Gauges specifically coloured for easy identification.

### Gauge Markings

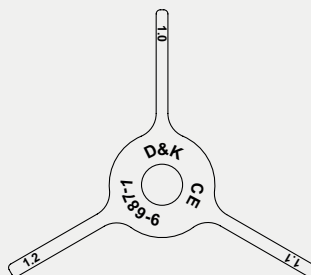

## Instrument Comparison Chart

### Product Name - Incision Gauge

Gauge Size	Colour Code	Additional Information	
1.0, 1.1 and 1.2mm	Pink	Incision Gauge	9-687-1
1.3, 1.4 and 1.5mm	Dark Blue	Incision Gauge	9-687-2
1.6, 1.7 and 1.8mm	Light Green	Incision Gauge	9-687-3
1.9, 2.0 and 2.1mm	Blue	Incision Gauge	9-687-4
2.2, 2.3 and 2.4mm	Gold	Incision Gauge	9-687-5
2.5, 2.6 and 2.7mm	Purple	Incision Gauge	9-687-6
2.8, 2.9 and 3.0mm	Copper	Incision Gauge	9-687-7

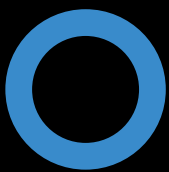

OPHTALMO  
THIS IS WHAT THE FUTURE LOOKS LIKE

- SURGICAL
- CONSUMABLES
- MEDICAL DEVICE