

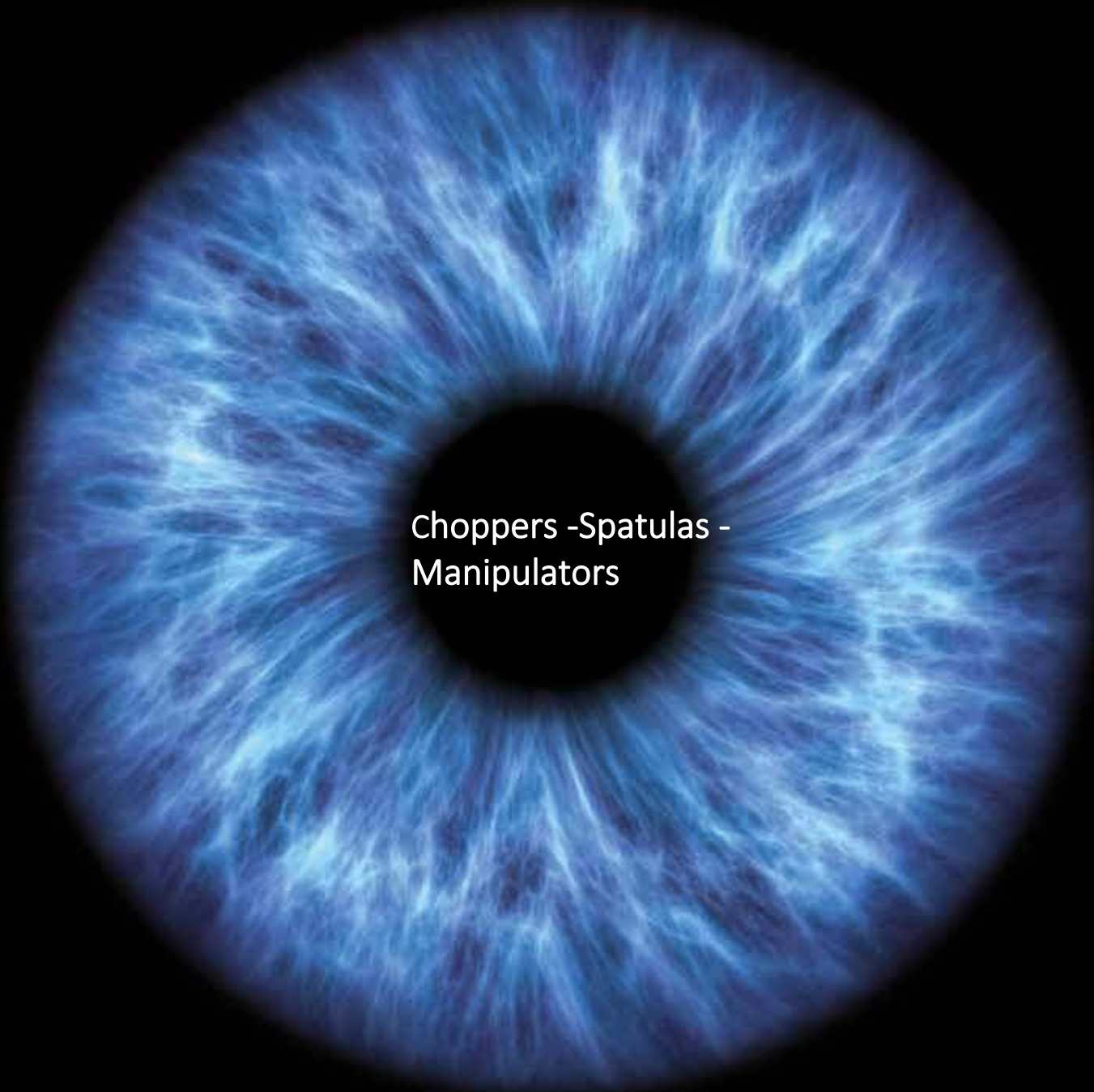

OPHTALMO



Choppers -Spatulas -
Manipulators

THIS IS WHAT THE FUTURE LOOKS LIKE



Choppers, Spatulas and Manipulators

- Horizontal Choppers
- Vertical Choppers
- Spatulas
- Hooks
- Manipulators and Rotators
- DMEK
- Femtosecond and LASIK Spatulas
- ICL Manipulators
- SMILE



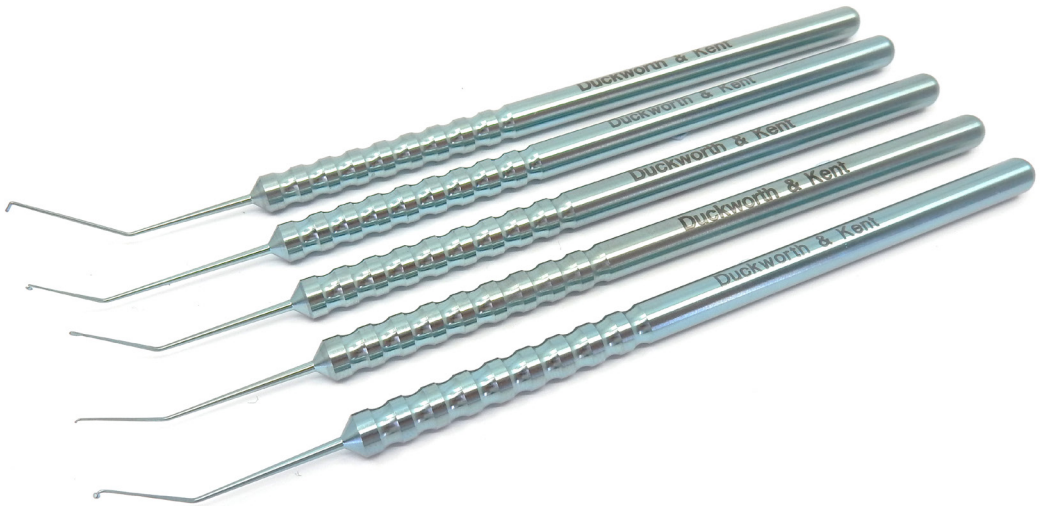

Titanium Reusable Ophthalmic Instruments



OPHTALMO

Horizontal Choppers

Horizontal choppers have a cutting edge which enables the chopper to cut through the nucleus in a horizontal direction.

The inserts are intended to illustrate the tip of a chopper and the direction of its cutting edge(-s) in relation to the shaft of the instrument as it is designed to be used.

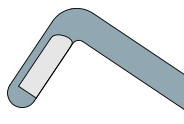

Side View

Our simplified 2D side view shows the shape of the instrument and size of the blade

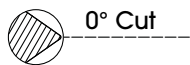

Cutting Edge Angle

Dashed line represents the axis of the shaft. Hatched area shows cross-section view of chopper tip shape. Degree refers to angle of chopper cutting edge in relation to shaft axis



Cutting Direction

Illustrates direction and angle that the instrument is designed to cut, viewed from above

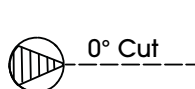

Symmetrical

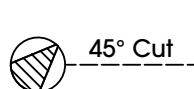

Asymmetrical

For use through the specified side port

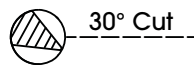
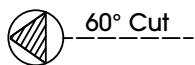

Nucleus Chopper

6-072-1

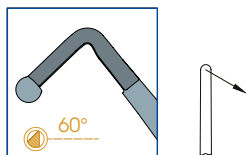

Bordeianu Nucleus Chopper

- Sharp inner sides of tip
- Tip length 1.75mm
- **Cutting edge 60° to axis**
- Tip to angle length 10mm
- 60° angled shaft
- **0.55mm constant diameter shaft to reduce leakage**
- Round handle, overall length 124mm
- **Designed for right-handed phaco surgeons to be used through the left side port**



OPHTALMO

Nucleus Chopper

6-074-1

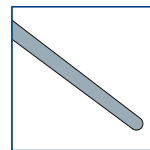
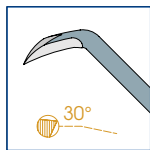

Araslan Nucleus Chopper and Spatula

Nucleus Cutter

- Sharp point
- Tip length 1.2mm
- **Cutting edge 30° to axis**
- Tip to angle length 9.8mm
- 60° angled curved shaft
- **Designed for right-handed phaco surgeons to be used through the left side port**

Spatula

- 0.4mm diameter blunt tip spatula
- Tip to angle length 11mm
- 45° angled shaft
- Round handle, overall length 119mm

Nucleus Chopper

6-075

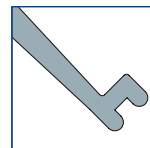
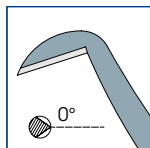

Packard 'Fat Boy' Nucleus Chopper and Capsule Retractor

Nucleus Cutter

- Straight, sharp inner sides of tip
- Tip length 1.26mm
- **Cutting edge 0° to axis**
- 50° angled shaft
- Tip to angle length 10mm
- **Tapered shaft to reduce leakage**

Capsule Retractor

- 0.25mm tip
- Tip to angle length 10mm
- 45° angled shaft
- **Tapered shaft to reduce leakage**
- Round handle, overall length 130mm

Nucleus Chopper

6-075-1

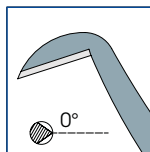

Packard 'Fat Boy' Nucleus Chopper

- Straight, sharp inner sides of tip
- Tip length 1.24mm
- **Cutting edge 0° to axis**
- Tip to angle length 10mm
- 50° angled shaft with slight curve
- Round handle, overall length 118mm

Nucleus Chopper

Best Seller 6-076

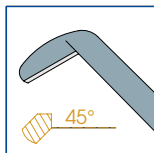

Rosen Nucleus Splitter

- Straight, sharp inner sides of tip
- **Tip length 0.8mm**
- **Cutting edge 45° to axis**
- Tip to angle length 10mm
- 45° angled shaft
- Round handle, overall length 119mm
- **Designed for right-handed phaco surgeons to be used through the left side port**

Nucleus Chopper

6-079

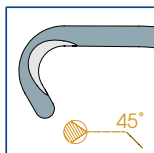

Green Nucleus Chopper

- Curved, sharp inner sides of tip
- Tip length 1mm
- **Cutting edge 45° to axis**
- Tip to angle length 9mm
- 65° angled shaft
- Round handle, overall length 117mm
- **Designed for right-handed phaco surgeons to be used through the left side port**

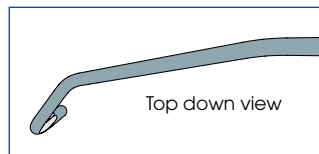

Nucleus Chopper

6-079-1

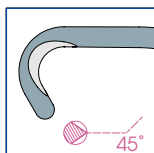

Green Nucleus Chopper

- Curved, sharp inner sides of tip
- Tip length 1mm
- **Cutting edge 45° to axis**
- Tip to angle length 9mm
- 65° angled shaft
- Round handle, overall length 117mm
- **Designed for left-handed phaco surgeons to be used through the right side port**

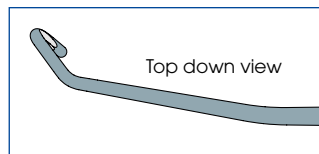

Nucleus Chopper

Best Seller 6-080

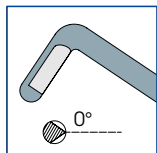

Nucleus Chopper

- Straight, sharp inner sides of tip
- Tip length 1.25mm
- **Cutting edge 0° to axis**
- Tip to angle length 14mm
- 45° angled shaft
- Round handle, overall length 122mm

Nucleus Chopper

6-080-2

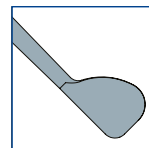
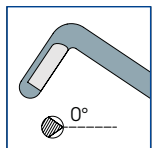

Nucleus Chopper and Rotator

Nucleus Chopper

- Straight, sharp inner sides of tip
- Tip length 1.25mm
- **Cutting edge 0° to axis**
- Tip to angle length 14mm
- 45° angled shaft

Nucleus Rotator

- 1.25 x 1mm blunt tip
- Tip to angle length 10mm
- 45° angled shaft
- Round handle, overall length 129mm

Nucleus Chopper

6-080-3

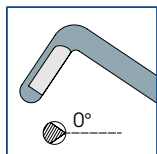

Find! Nucleus Chopper

- Straight, sharp inner sides of tip
- Tip length 1.25mm
- **Cutting edge 0° to axis**
- Tip to angle length 14mm
- 45° angled shaft
- Round handle, overall length 122mm
- **Parallel shaft to reduce leakage**



Nucleus Chopper

6-080-4

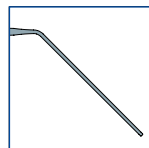
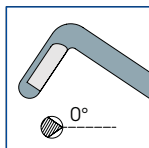

Find! Nucleus Chopper and Spatula

Nucleus Chopper

- Straight, sharp inner sides of tip
- Tip length 1.25mm
- **Cutting edge 0° to axis**
- Tip to angle length 14mm
- 45° angled shaft

Spatula

- 0.5mm width, 0.25mm thickness
- Tip to angle length 12mm
- 45° angled shaft
- Round handle, overall length 131mm

Nucleus Chopper

Best Seller 6-081

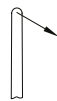
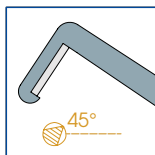

Nucleus Chopper

- Straight, sharp inner sides of tip
- Tip length 1.25mm
- **Cutting edge 45° to axis**
- Tip to angle length 14mm
- 45° angled shaft
- Round handle, overall length 122mm
- **Designed for right-handed phaco surgeons to be used through the left side port**

Nucleus Chopper

6-081-3

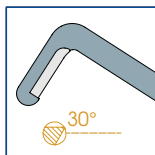

Nucleus Chopper

- Straight, sharp inner / outer sides of tip
- Tip length 1.25mm
- **Cutting edge 30° to axis**
- Tip to angle length 10.5mm
- 45° angled shaft
- Round handle, overall length 119mm
- **Designed for right-handed phaco surgeons to be used through the left side port**



Nucleus Chopper

6-083

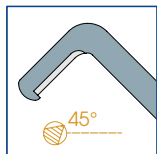

Hara Nucleus Chopper

- Straight, sharp inner sides of tip
- Tip length 1.15mm
- **Cutting edge 45° to axis**
- Tip to angle length 11mm
- 45° angled shaft
- Round handle, overall length 116mm
- **Designed for right-handed phaco surgeons to be used through the left side port**

Nucleus Chopper

6-083-1

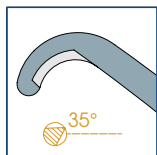

Hara Nucleus Chopper

- Curved, sharp inner sides of tip
- Tip length 1.1mm
- **Cutting edge 35° to axis**
- Tip to angle length 11mm
- 45° angled shaft
- Round handle, overall length 115mm
- **Designed for right-handed phaco surgeons to be used through the left side port**

Nucleus Chopper

6-083-5

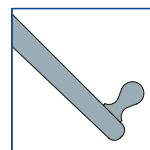
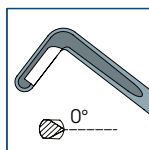

Sibilio Nucleus Chopper and Manipulator

Nucleus Chopper

- Straight sharp inner sides of tip
- Tip length 1.25mm
- **Cutting edge 0° to axis**
- Tip to angle length 11mm
- 45° angled shaft

Manipulator

- 0.3mm diameter tip
- Tip to angle length 11mm
- 45° angled shaft
- Round handle, overall length 132mm



Nucleus Chopper

6-085

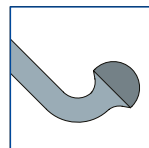
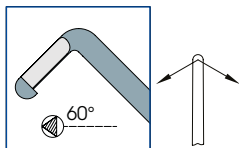

Barrett Nucleus Chopper and Manipulator

Nucleus Chopper

- Straight, sharp inner/outer sides of tip
- Tip length 1.25mm
- **Two cutting edges 60° to axis**
- Tip to angle length 14mm
- 45° angled shaft

Manipulator

- 0.65mm mushroom tip
- Tip to angle length 10mm
- 45° angled shaft
- **Barrett balanced set handle**, overall length 124mm

Nucleus Chopper

Best Seller 6-085-1

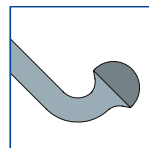
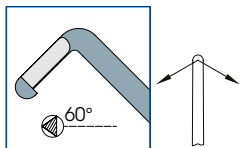

Barrett Nucleus Chopper and Manipulator

Nucleus Chopper

- Straight, sharp inner/outer sides of tip
- Tip length 1.25mm
- **Two cutting edges 60° to axis**
- Tip to angle length 14mm
- 45° angled shaft

Manipulator

- 0.65mm mushroom tip
- Tip to angle length 10mm
- 45° angled shaft
- Round handle, overall length 130mm

Nucleus Chopper

6-085-3

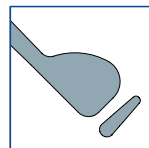
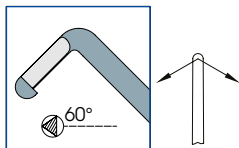

Nucleus Chopper and Rotator

Nucleus Chopper

- Straight, sharp inner sides of tip
- Tip length 1.25mm
- **Two cutting edges 60° to axis**
- Tip to angle length 14mm
- 45° angled shaft

Nucleus Rotator

- 1.25 x 1mm blunt tip
- Tip to angle length 10mm
- 45° angled shaft
- Round handle, overall length 129mm

Nucleus Chopper

Best Seller

6-085-6

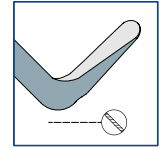
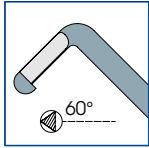

Barrett Nucleus Chopper and Divider

Nucleus Chopper

- Blunt ended tip, straight sharp inner sides
- Tip length 1.25mm
- **Two cutting edges 60° to axis**
- Tip to angle length 14mm
- 45° angled shaft

Nucleus Divider

- Sharp edge at base of tip
- Tip length 1.25mm
- Tip to angle length 10mm
- 45° angled shaft
- **Barrett balance set handle**, overall length 125mm

Nucleus Chopper

6-085-8

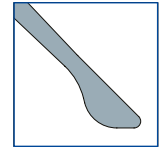
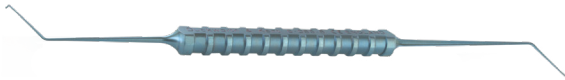
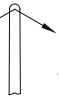
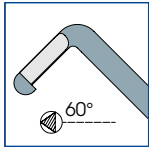

Nucleus Chopper and Rotator

Nucleus Chopper

- Straight, sharp inner / outer sides of tip
- Tip length 1.25mm
- **Two cutting edges 60° to axis**
- Tip to angle length 14mm
- 45° angled shaft

Nucleus Rotator

- 1 x 0.5mm blunt tip
- Tip to angle length 10mm
- 45° angled shaft
- **Barrett balanced set handle**, overall length 125mm

Nucleus Chopper

6-086

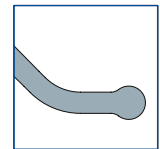
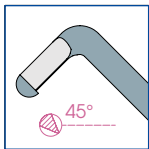

Inamura Nucleus Chopper and Manipulator

Nucleus Chopper

- Straight, sharp inner sides of tip
- Tip length 1.1mm
- **Cutting edge 45° to axis**
- Tip to angle length 11mm
- 45° angled shaft

Manipulator

- 0.55mm ball shaped tip
- Tip to angle length 11mm
- 45° angled shaft
- Round handle, overall length 129mm

• **Designed for left-handed phaco surgeons to be used through the right side port**



Nucleus Chopper

6-086-1

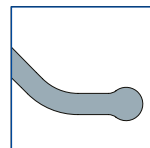
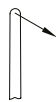
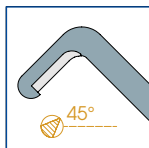

Inamura Nucleus Chopper and Manipulator

Nucleus Chopper

- Straight, sharp inner sides of tip
- Tip length 1.1mm
- **Cutting edge 45° to axis**
- Tip to angle length 11mm
- 45° angled shaft
- **Designed for right-handed phaco surgeons to be used through the left side port**

Manipulator

- 0.55mm ball shaped tip
- Tip to angle length 11mm
- 45° angled shaft
- Round handle, overall length 129mm

Nucleus Chopper

6-086-5

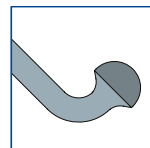
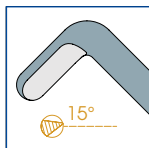

Jakobsen-Barrett Nucleus Chopper and Manipulator

Nucleus Chopper

- Blunt ended tip, straight sharp inner sides
- Tip length 1mm
- **Cutting edge 15° to axis**
- Tip to angle length 10mm
- 45° angled shaft
- **Designed for right-handed phaco surgeons to be used through the left side port**

Manipulator

- 0.65mm **highly polished** mushroom
- Tip to angle length 10mm
- 45° angled shaft
- Round handle, overall length 126mm

Nucleus Chopper

6-086-6

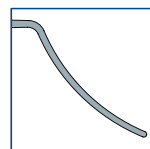
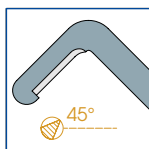

Nucleus Chopper and Repositor

Nucleus Chopper

- Straight, sharp inner sides of tip
- Tip length 1.25mm
- **Cutting edge 45° to axis**
- Tip to angle length 14mm
- 45° angled shaft
- **Designed for right-handed phaco surgeons to be used through the left side port**

Repositor

- 0.5mm diameter blunt tip spatula
- Tip to angle length 14mm
- 45° angled shaft
- Round handle, overall length 132mm



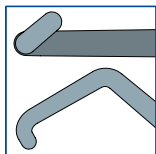

Inamura RACE Hook, Right Hand

- Tip to angle length 0.5mm
- Tip length, angle to angle, 1.5mm
- 40° angle to tip length 9mm
- Round handle, overall length 119mm
- **Designed for left-handed phaco surgeons to be used through the right side port**

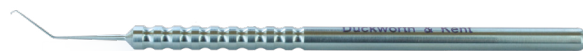
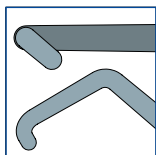

Inamura RACE Hook, Left Hand

- Tip to angle length 0.5mm
- Tip length, angle to angle, 1.5mm
- 40° angle to tip length 9mm
- Round handle, overall length 119mm
- **Designed for right-handed phaco surgeons to be used through the left side port**

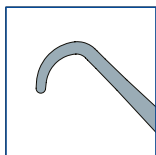

Scott Femto Nucleus Chopper

- Curved, smooth round tip
- Tip to angle length 10mm
- 45° angled shaft
- **0.45mm constant diameter shaft to reduce leakage**
- Round handle, overall length 120mm

Vertical Choppers

Vertical choppers have a cutting edge or sharp point enables the chopper to split or crack the nucleus in a vertical direction.

This diagram illustrates how we translate a tip view into a visual representation of the blade shape and position of the vertical chopper.

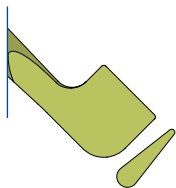

Axe

Coloured tip view with view of Axe from above

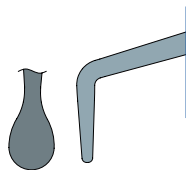

Divider

Coloured tip view with view of divider from above

Nucleus Chopper

6-074-2

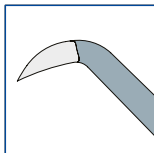

Parmar Vertical Chopper

- Sharp point
- Tip length 0.75mm
- **Cutting edge 0° to axis**
- Tip to angle length 10mm
- 45° angled shaft
- Round handle, overall length 115mm

Nucleus Chopper

6-085-2

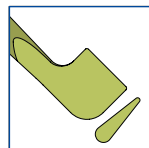
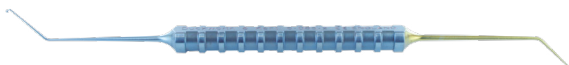
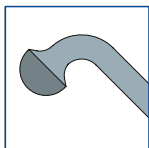

Barrett Phaco-Axe and Manipulator

Manipulator

- 0.65mm **highly polished** mushroom rotator
- Tip to angle length 10mm
- 45° angled shaft

Phaco-Axe

- 0.75 x 0.75mm axe
- Tip to angle length 10mm
- 45° angled shaft
- **Barrett balance handle**, overall length 122mm
- **Axe direction suitable for a right-handed phaco surgeon to be used through the left side port**



OPHTALMO

Nucleus Chopper

Best Seller 6-087

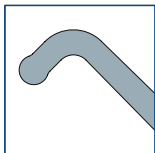

Mackool Phaco Chopper

- Straight miniature 0.3mm diameter ball shaped tip
- Tip length 0.6mm
- Tip to angle length 10mm
- 45° angled shaft
- Round handle, overall length 119mm

Nucleus Chopper

6-087-1

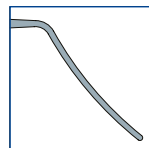
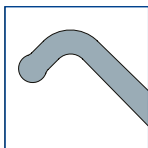

Mackool Phaco Chopper and Spatula

Chopper

- Straight miniature 0.35mm diameter ball shaped tip
- Tip length 0.7mm
- Tip to angle length 10mm
- 45° angled shaft

Spatula

- 0.4mm diameter blunt tip spatula
- Tip to angle length 11mm
- 50° angled shaft
- Round handle, overall length 114mm

Nucleus Divider

Best Seller 6-090

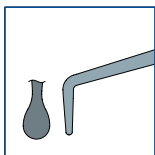

Nucleus Dividing Hook

- Straight, bulbous shape flat tip
- Tip width 0.62mm, length 0.9mm
- Tip to angle length 11mm
- 35° angled shaft
- Round handle, overall length 115mm



Nucleus Divider

6-090-3

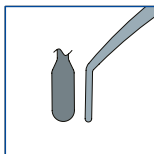

Sugiura Nucleus Dividing Hook

- Paddle shape divider
- Tip 1.5mm long by 0.6mm wide
- Tip to angle length 10mm
- Curved shaft at 45° angle
- Round handle, overall length 113mm



Nucleus Divider

6-090-6

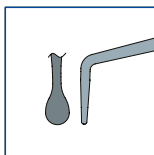

Wada Nucleus Dividing Hook

- Paddle shape divider
- Thinner dividing edge on right side
- Tip 1.35mm long by 0.6mm wide
- Tip to angle length 11mm
- Straight shaft at 40° angle
- Round handle, overall length 114mm
- **Designed for right-handed phaco surgeons to be used through the left side port**



Nucleus Divider

6-090-7

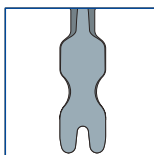

Rana-Ota Nucleus Dividing Hook

- Vertical paddle shaped divider with slot
- Tip 1.75mm length
- Tip to angle length 11mm
- Straight shaft at 40° angle
- Round handle, overall length 114mm



Nucleus Divider

Best Seller

6-090-8

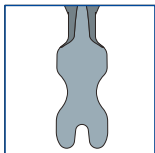

Rana-Ota Nucleus Dividing Hook

- Vertical paddle shaped divider with slot
- Tip 1.4mm length
- Tip to angle length 11mm
- Straight shaft at 40° angle
- Round handle, overall length 114mm

Nucleus Chopper

6-093

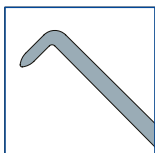

Vertical Chopper

- Straight, blunt tip
- Tip length 1mm
- Tip to angle length 12mm
- 45° angled shaft
- Round handle, overall length 121mm



Spatula

6-099

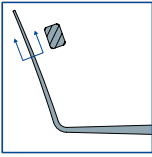

Mackool-Barraquer Spatula

- 0.45mm width, 0.25mm thickness
- Tip to angle length 15mm
- 70° angled blade
- Round handle, overall length 115mm

Spatula

Best Seller 6-099-1

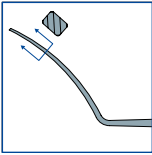

Iris Reposer

- 0.45mm width, 0.25mm thickness
- Tip to angle length 15mm
- 45° angled blade
- Highly polished internal face of curved tip
- Round handle, overall length 120mm

Spatula

6-099-2

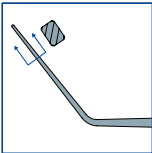

Spatula

- 0.5mm width, 0.2mm thickness
- Tip to angle length 10mm
- 50° angled blade
- Highly polished underside of blade
- Round handle, overall length 120mm

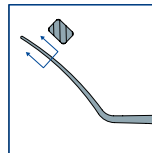

6-099-4

Spatula

- 45° curved blade

Spatula

6-099-3

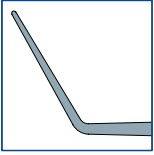

Anwar Keratoplasty Spatula

- 0.25mm diameter blunt tip
- Tip tapered from 0.5mm diameter
- Tip to angle length 7mm
- 60° angled blade
- Round handle, overall length 115mm

Spatula

Best Seller

6-100

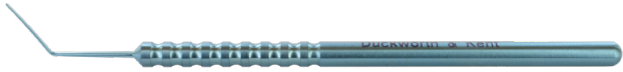
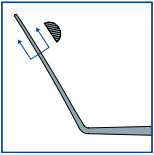

Castroviejo Style Cyclodialysis Spatula

- 0.7mm width, 0.25mm thickness
- Tip to angle length 13mm
- 60° slightly curved blade
- Round handle, overall length 118mm

Spatula

6-101

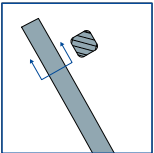

Barraquer Style Iris Spatula

- 0.25mm width, 0.25mm thickness
- Tip to angle length 15mm
- 70° angled blade
- Round handle, overall length 115mm

Spatula

6-102

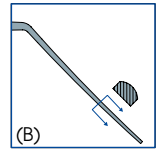
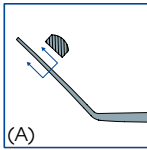

Castroviejo Style Double Ended Synechia Spatula

(A) Spatula

- 0.5mm width, 0.25mm thickness
- **Tip to angle length 10mm**
- 45° angled blade

(B) Spatula

- 0.5mm width, 0.25mm thickness
- **Tip to angle length 15mm**
- 45° angled blade
- Round handle, overall length 130mm

Spatula

6-105-1

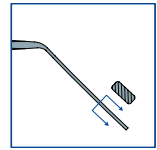
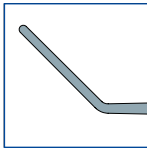

Double Ended Spatula

Rounded tip

- 0.6mm diameter tip
- Tip to angle length 8mm
- 45° angled blade

Flattened tip

- 0.2mm x 0.5mm highly polished tip
- Tip to angle length 8mm
- 45° angled blade
- Round handle, overall length 123mm

Spatula

6-107

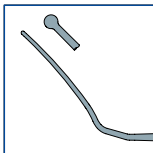

Round Tip Spatula

- 0.3mm width spatula with a 0.65mm diameter round tip
- Tip to angle length 11mm
- 47° angled curved blade
- Round handle, overall length 121mm

Hook

6-112

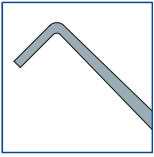

Anwar Keratoplasty Hook

- 0.18mm diameter tip for 1mm height
- Flat face at tip
- Tip to angle length 10mm
- 45° angled shaft
- Round handle, overall length 119mm

Iris Hook

6-124

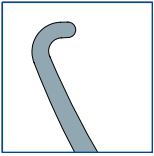

Osher Iris Tuck Eliminator

- 0.18mm x 0.6mm hook
- Tip to curve length 10.5mm
- Curved shaft
- Round handle, overall length 119mm

Sinskey Hook

6-245

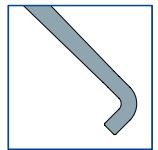
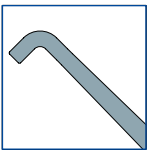

Double Ended Sinskey Hook

- **2 x 0.2mm diameter tips, 0.38mm height**
- Tip to angle length 10mm
- 45° angled shaft
- Round handle, overall length 125mm

Sinskey Hook

6-249

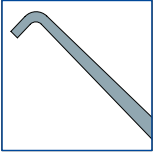

Delicate Sinskey Hook

- **0.12mm diameter tip, 0.35mm height**
- Tip to angle length 10mm
- 45° angled shaft
- Round handle, overall length 119mm



Sinskey Hook

Best Seller

6-250

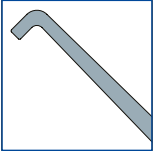

Sinskey Hook

- **0.18mm diameter tip, 0.35mm height**
- Tip to angle length 10mm
- 45° angled shaft
- Round handle, overall length 119mm



Best Seller

6-251

Sinskey Hook

- Straight shaft
- Round handle, overall length 121mm

Hook

6-500

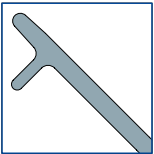

Fenzl Hook

- 0.13mm diameter, 0.5mm height dialler
- Tip to angle length 9mm
- 45° angled shaft
- Round handle, overall length 117mm



IOL Hook

Best Seller 6-400

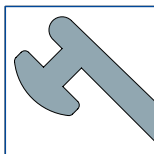

Kuglen IOL Hook

- 0.76mm x 0.75mm x 0.25mm rotator tip
- Tip to angle length 9mm
- 45° angled shaft
- Round handle, overall length 122mm



IOL Hook

6-400-1

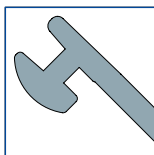

Mackool-Kuglen IOL Hook

- 0.88mm x 0.86mm x 0.25mm rotator tip
- Tip to angle length 9mm
- 45° angled shaft
- Round handle, overall length 118mm



IOL Hook

6-464-1

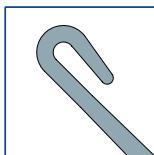

Ota Fine IOL Hook

- **Reverse hook, 0.20mm diameter, 1mm length reverse hook facing upwards**
- Tip to angle length 10mm
- 45° angled shaft
- Round handle, overall length 118mm



IOL Manipulator

6-417

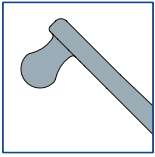

Ogawa IOL Manipulator

- 0.5mm diameter tip
- Tip to angle length 11mm
- 45° angled shaft
- Round handle, overall length 119mm

IOL Manipulator

6-418

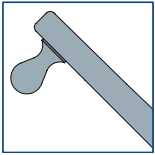

Ogawa Miniature IOL Manipulator

- **0.3mm diameter tip**
- Tip to angle length 11mm
- 45° angled shaft
- Round handle, overall length 119mm

IOL Manipulator

6-418-1

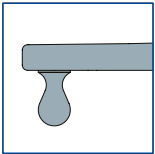

Ogawa Miniature IOL Manipulator, Straight

- 0.3mm diameter tip
- **Straight shaft**
- Round handle, overall length 122mm

IOL Manipulator

6-418-2

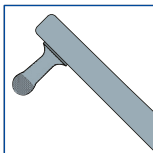

Daya Textured IOL Manipulator

- 0.2mm diameter tip
- **Lightly textured tip**
- Tip to angle length 11mm
- 45° angled shaft
- Round handle, overall length 119mm

IOL Manipulator

Best Seller 6-450

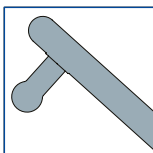

Lester IOL Manipulator

- 0.4mm diameter tip
- Tip to angle length 9mm
- 45° angled shaft
- Round handle, overall length 118mm

IOL Manipulator

6-460

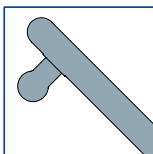

Hirschman IOL Manipulator

- 0.4mm diameter tip
- Tip to angle length 12mm
- 45° angled shaft
- Round handle, overall length 120mm



IOL Manipulator

6-467

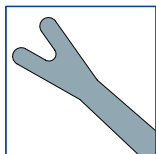

IOL Manipulator

- **0.67mm vertically forked tip**
- Tip to angle length 9mm
- 45° angled shaft
- Round handle, overall length 117mm

IOL Manipulator

Best Seller

6-469

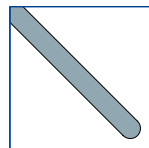
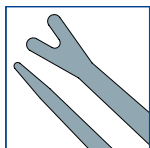

IOL Manipulator and Spatula

IOL Manipulator

- **0.67mm vertically forked tip**
- Tip to angle length 9mm
- 45° angled shaft

Spatula

- 0.55mm diameter spatula
- Tip to angle length 11.5mm
- 45° angled shaft
- Round handle, overall length 125mm

IOL Manipulator

6-469-1

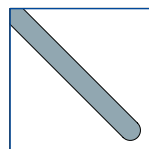
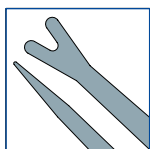

IOL Manipulator and Spatula

IOL Manipulator

- **0.67mm delicate vertically forked tip**
- Tip to angle length 9mm
- 45° angled shaft

Spatula

- 0.55mm diameter spatula
- Tip to angle length 11.5mm
- 45° angled shaft
- Round handle, overall length 125mm



Nucleus Manipulator

6-472

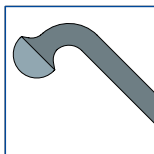

Barrett Nucleus Manipulator

- 0.65mm mushroom style tip
- Tip to angle length 10mm
- 45° angled shaft
- **Barrett balanced set handle**, overall length 119mm

Nucleus Manipulator

Best Seller 6-472-1

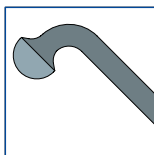

Nucleus Manipulator

- 0.65mm mushroom style tip
- Tip to angle length 10mm
- 45° angled shaft
- Round handle, overall length 119mm

Nucleus Rotator

6-470

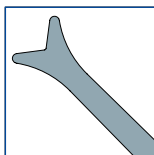

Bechert Nucleus Rotator

- 0.78mm vertically forked tip
- Tip to angle length 10mm
- 45° angled shaft
- Round handle, overall length 118mm

Nucleus Rotator

6-476

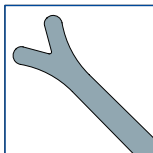

Mackool Nucleus Rotator

- 0.78mm vertically forked tip
- Tip to angle length 12mm
- 45° angled shaft
- Round handle, overall length 120mm

Nucleus Rotator

6-491-2

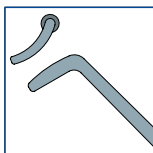

Nucleus Rotator

- 0.2mm by 0.3mm tip
- 1.75mm tip length, **curved to right**
- Tip to angle length 10mm
- 45° angled shaft
- Round handle, overall length 119mm
- **Designed for right-handed phaco surgeons to be used through the left side port**

Nucleus Rotator

6-491-3

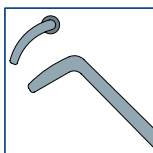

Nucleus Rotator

- 0.2mm by 0.3mm tip
- 1.75mm tip length, **curved to left**
- Tip to angle length 10mm
- 45° angled shaft
- Round handle, overall length 119mm
- **Designed for left-handed phaco surgeons to be used through the right side port**

Nucleus Rotator

6-494

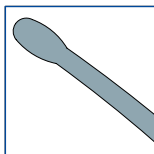

Nucleus Rotator

- 0.65mm diameter tip
- Tip to angle length 12mm
- 45° angled shaft
- Round handle, overall length 120mm

Nucleus Rotator

6-495

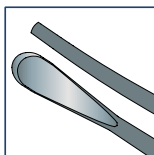

Brazier Nucleus Rotator

- 0.75mm blunt tip
- Tip to curve length 23mm
- 35° curved shaft
- Round handle, overall length 118mm

Nucleus Rotator

Best Seller 6-496

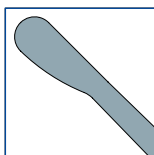

Drysdale Rotator, Small

- **0.5mm x 1.3mm round ended paddle**
- Tip to angle length 10mm
- 45° angled shaft
- Round handle, overall length 118mm

Nucleus Rotator

6-496-1

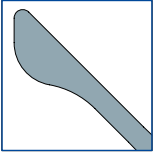

Drysdale Rotator, Angled

- **0.5mm x 1.4mm angled paddle**
- Tip to angle length 10mm
- 45° angled shaft
- Round handle, overall length 118mm

Nucleus Rotator

6-496-2

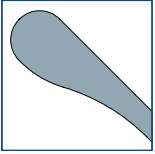

Drysdale Rotator, Large

- **0.8mm x 2.4mm large round ended paddle**
- Tip to angle length 10mm
- 45° angled shaft
- Round handle, overall length 118mm

DMEK Hook

Best Seller 6-250-1

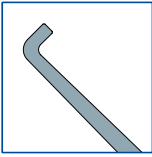

Reverse Sinskey Hook

- **0.18mm diameter tip, 0.35mm height pointing upwards**
- Tip to angle length 10mm
- 45° angled shaft
- Round handle, overall length 118mm

DMEK Hook

6-250-2

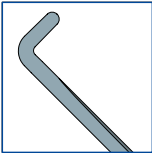

Güell Reverse Sinskey Hook

- **0.22mm diameter rounded tip, 0.7mm height pointing upwards**
- Tip to angle length 10mm
- 45° angled shaft
- Round handle, overall length 118mm

DMEK Hook

6-258

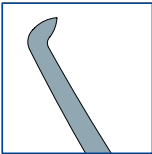

Descemet's Hook

- 0.2mm diameter, 0.5mm height
- Pointed tip
- Tip to angle length 14mm
- 45° slightly curved shaft
- Round handle, overall length 117mm

DMEK Scraper

6-256

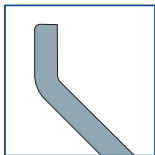

Güell Descemet's Scraper

- 0.2mm tip width, 0.45mm height
- Tip to angle length 10mm
- 45° angled shaft
- Round handle, overall length 122mm

DMEK Scraper

6-257

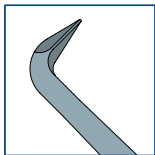

Daya Descemet's Scraper

- 0.2mm tip width, 0.5mm height
- Sharp edges around tip
- Tip to angle length 14mm
- 45° angled shaft
- Round handle, overall length 121mm



Femto Spatula

6-848

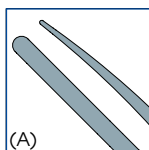

(A)

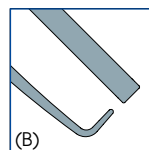

(B)

Krokchings Double Ended Femto Spatula

(A) Femto Spatula

- Fine flat tapered tip from 0.3mm
- Tip to angle 4mm
- 45° slightly curved blade
- Used to open primary and secondary femto created incisions

(B) Femto Spatula

- Fine point, 0.5mm width x 0.5mm height
- Fine point 90° to blade
- Tip to angle 4mm
- 45° slightly curved blade
- Used to open limbal relaxing incisions (LRI)
- Round handle, overall length 119mm

Femto Spatula

6-855

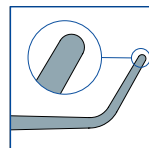
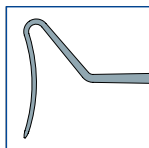

Femto Flap Lifter and Re-treatment Spatula

Flap Lifter

- 0.4mm diameter, smooth polished surface
- Curved shaft, 12mm length

Re-treatment Spatula

- 0.15mm tip diameter, smooth polished surface
- **Round shaped tip**
- Tip to angle length 3mm
- 60° angled blade
- Round handle, overall length 123mm

Femto Spatula

Best Seller

6-855-1

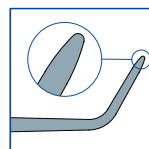
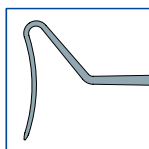

Femto Flap Lifter and Re-treatment Spatula

Flap Lifter

- 0.4mm diameter, smooth polished surface
- Curved shaft, 12mm length

Re-treatment Spatula

- 0.15mm tip diameter, smooth polished surface
- **Bullet shaped tip**
- Tip to angle length 3mm
- 60° angled blade
- Round handle, overall length 123mm



Femto Spatula

6-856

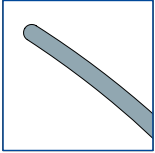

Femto Spatula

- 0.5mm spatula
- Smooth slightly curved shaft with blunt tip
- Tip to angle length 10mm
- 45° angled blade
- Round handle, overall length 118mm

Epithelial Separator

6-866

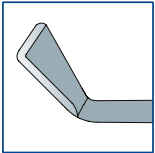

Epithelial Separator

- 5mm triangular-shaped tip
- 45° angled blade
- Round handle, overall length 119mm

LASIK Spatula

6-870

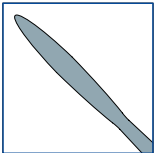

Buratto LASIK Oval Spatula

- 1.3mm wide, oval shaped spatula
- Tip to angle length 10.5mm
- 35° angled curved blade
- Round handle, overall length 122mm



ICL Manipulator

6-479

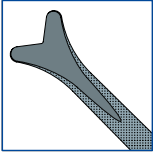

Deitz ICL Manipulator

- 0.78mm vertically forked tip
- **Lightly textured surface on underside from tip to angle**
- Tip to angle length 11mm
- 45° angled shaft
- Round handle, overall length 119mm

ICL Manipulator

Best Seller 6-481

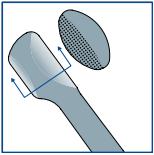

Pallikaris ICL Manipulator

- 0.7mm x 0.4mm oval shaped tip
- Textured finish on rounder side
- Tip to angle length 12mm
- 45° slightly curved shaft
- Round handle, overall length 119mm

ICL Manipulator

6-482

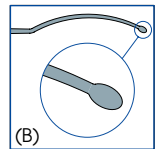
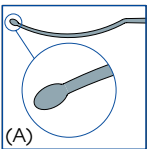

Bylsma Double Ended ICL Manipulator

(A) Manipulator

- 0.6mm x 1.1mm oval shaped tip
- Tip to angle length 12.5mm
- 45° angled curved shaft (curved left)

(B) Manipulator

- 0.6mm x 1.1mm oval shaped tip
- Tip to angle length 12.5mm
- 45° angled curved shaft (curved right)
- Round handle, overall length 143mm



SMILE Dissector

6-835

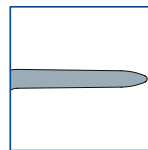
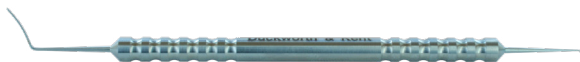
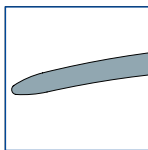

SMILE Double Ended Dissector

Bullet Shaped Tip

- **0.4mm diameter bullet shaped tip**
- Tip to angle length 9.5mm
- 60° angled curved shaft
- **Laser markings on angled shaft at 7mm, 7.5mm and 8mm from tip**

Bullet Shaped Tip

- **0.25mm diameter bullet shaped tip**
- Tip to angle length 2mm
- 60° angled shaft
- Round handle, overall length 117mm

SMILE Dissector

Best Seller 6-836

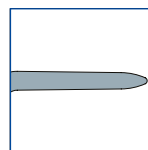
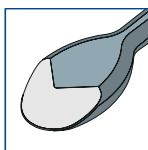

SMILE Double Ended Dissector with Spoon Tip

Spoon Shaped Tip

- 1.25 x 0.35mm spoon-shaped tip
- Tip to angle length 9.5mm
- 70° angled curved shaft
- **Laser markings on angled shaft at 7mm, 7.5mm and 8mm from tip**

Bullet Shaped Tip

- **0.25mm diameter bullet shaped tip**
- Tip to angle length 2mm
- 60° angled shaft
- Round handle, overall length 116mm

SMILE Dissector

6-836-1

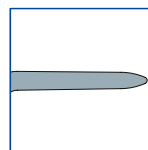
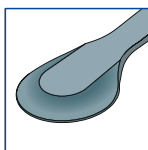

SMILE Double Ended Dissector with Tanageri Spoon Tip

Spoon Shaped Tip

- 1.3 x 0.2mm semi-sharp spoon-shaped tip
- Tip to angle length 8.5mm
- 60° angled straight shaft
- **Laser markings on angled shaft at 7mm, 7.5mm and 8mm from tip**

Bullet Shaped Tip

- **0.25mm diameter bullet shaped tip**
- Tip to angle length 1.5mm
- 60° angled shaft
- Round handle, overall length 116mm



SMILE Dissector

Best Seller

6-836-2

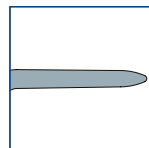
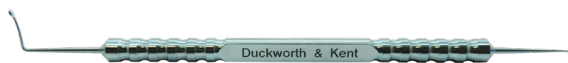
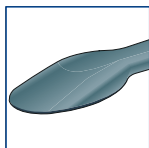

Reinstein Double Ended Lenticule Separator

Spoon Shaped Tip

- **1.2 x 0.4mm smooth spoon-shaped tip**
- Tip to angle length 8.5mm
- 90° angled curved shaft

Bullet Shaped Tip

- **0.22mm diameter bullet shaped tip**
- Tip to angle length 2mm
- 60° angled shaft
- Round handle, overall length 114mm

SMILE Dissector

6-839

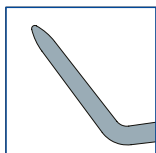

SMILE Short Dissector

- **0.22mm diameter bullet shaped tip**
- Tip to angle length 2mm
- 60° angled shaft
- Round handle, overall length 112mm

SMILE Hook

6-837

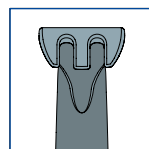
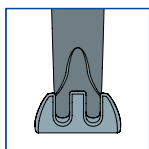

SMILE Double Ended Lenticule Hook

- 1mm wide 3 pronged hooks tip up and tip down
- Tip to angle length 10mm
- 70° angled shafts
- Round handle, overall length 123mm



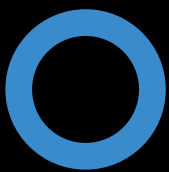

OPHTALMO
THIS IS WHAT THE FUTURE LOOKS LIKE

- SURGICAL
- CONSUMABLES
- MEDICAL DEVICE